



RPE Srl

Leader in Fluid Management Control

100%
MADE IN ITALY

Solutions for the Sanitary Market

**Whether you make electronic taps, faucet, showers, urinals, hydro
massage showers, with infrared or sensor-less technology....**

RPE has a full range of solutions

**with technological advancements, service and quality products
since more than 50 years**

www.rpesrl.it



RPE for the Sanitary Market

Existing Products Range

FAUCET – TAPS – URINALS – SHOWER TOILETS

100%
MADE IN ITALY

2

MICRO SERIES

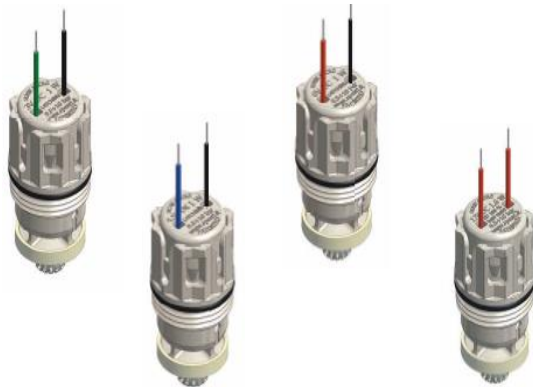

R SERIES MINI



THIRD SERIES

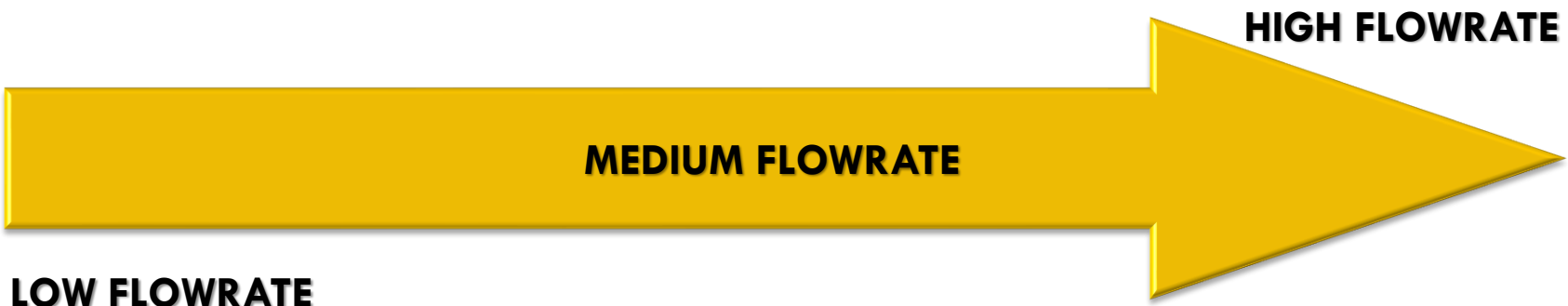

SERIE MICRO RPE 6V bistabile

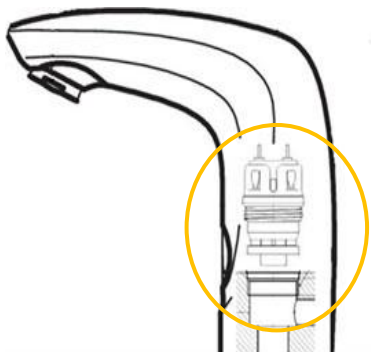
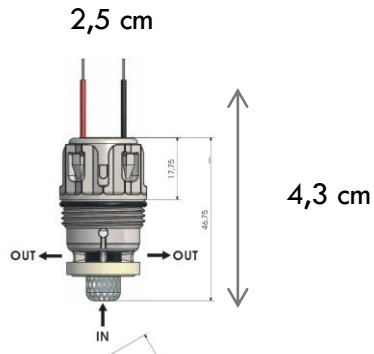

AXIAL VALVE

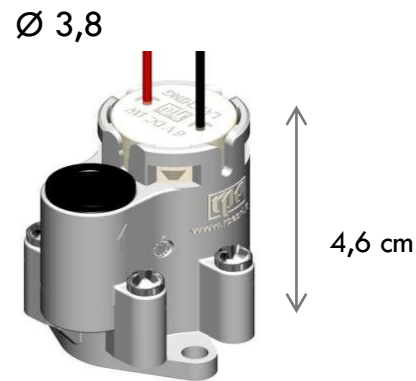

FLUSH VALVE TERZA SERIE

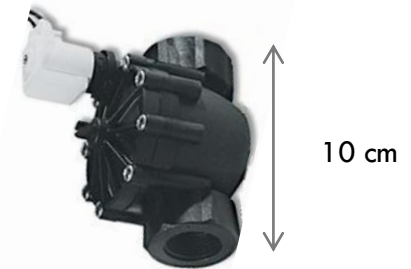



RPE for the Sanitary Market

R- MINI Series

100%
MADE IN ITALY

4

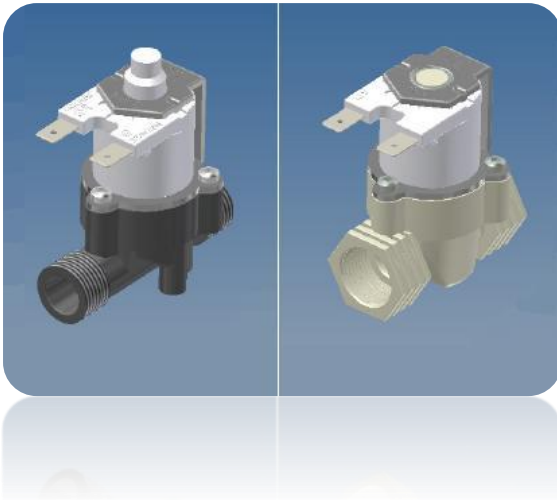

- Compact: valves dimensions are 6,5x3,8cm
- High Performances: flow rates beyond 70L/min with pressure from 0,2 to 10 bar
- Modular: bodies available with connections: BSP thread, J. Guest, Hose Tail
- Precise, accurate and repeatable
- Reliable, with a long service life
- 100% tested before delivery

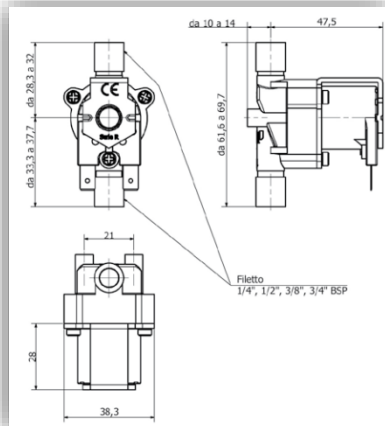



RPE for the Sanitary Market

R- MINI Series

100%
MADE IN ITALY

5

PHYSICAL SPECIFICATIONS

Valve body: PA 66 - 30% GF
Diaphragm: NBR; EPDM; LSR
Core: Stainless steel
Coils: F class (155°)
Assembly: With screws, serviceable

WORKING SPECIFICATIONS

Working pressure: 0,2 - 10 bar
Room temperature: Tu 60° C
Fluid temperature: Tm 25° C - Tm 60° C - ED 100%
Tm 90° C (3 ON - 5 OFF)
Orifice: ND 11 mm
Control: NC; NO; Latching
Fluid direction: Unidirectional
CV R Series Mini: See next pages
CV R Series Mini G: 27,07 L/min

ELECTRICAL CONNECTIONS

Faston 6,3 x 0,8 mm
Unipolar wires max 5000 mm
Bipolar wires max 5000 mm



Modello Model	IN	OUT	Diametro nominale Nominal diameter	M.O.Q. (pcs)	Filtro Filter (IN)	Regolatore Regulator (IN)	Check valve (IN)	Staffa Bracket	Riduttore Restrictor (OUT)	Check valve (OUT)
210	1/8" F	1/8" F	11 mm	160						
310	1/4" F	1/4" F	11 mm	160						
311	1/4" M	1/4" M	11 mm	160						
410	3/8" F	3/8" F	11 mm	160						
411	3/8" M	3/8" M	11 mm	160						
510	1/2" F	1/2" F	11 mm	160						
511	1/2" M	1/2" M	11 mm	160						
611	3/4" M	3/4" M	11 mm	160	✓					
015	PG 10 mm	PG 10 mm	11 mm	160						
1145	JG 8 mm	JG 8 mm	11 mm	160						



Modello Model	IN	OUT	Diametro nominale Nominal diameter	M.O.Q. (pcs)	Filtro Filter (IN)	Regolatore Regulator (IN)	Check valve (IN)	Staffa Bracket	Riduttore Restrictor (OUT)	Check valve (OUT)
118	JG 1/4"	JG 1/4"	11 mm	160			✓		✓	✓
119	JG 3/8"	JG 3/8"	11 mm	160			✓		✓	✓
113	JG 6 mm	JG 6 mm	11 mm	160			✓		✓	✓
1146	JG 8 mm	JG 8 mm	11 mm	160			✓		✓	✓
115	JG 10 mm	JG 10 mm	11 mm	160			✓		✓	✓
117	JG 15 mm	JG 15 mm	11 mm	160						

Legenda / Key:

PG = Portagomma / Hose tail

JG = Attacco rapido / Quick coupling



RPE for the Sanitary Market

R- MINI Series

100%
MADE IN ITALY

6

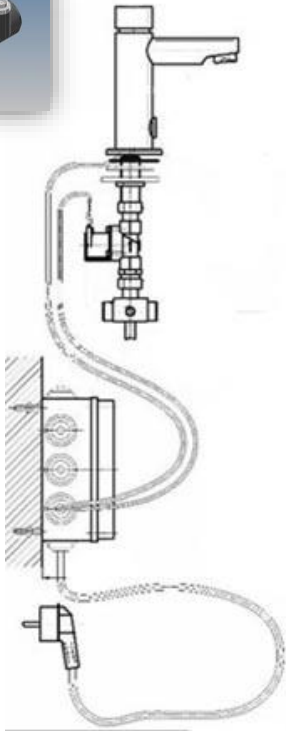

Possible configurations



1. With manual mixing



2. With under-sink mixing regulation



3. Mono water



RPE for the Sanitary Market

RPE MICRO

100%
MADE IN ITALY

7

3V

4,5V

6V

12V

24V

4 DIFFERENT VERSIONS



FEATURES

1. COMPACT

- Micro series measures 4,3x2,5cm
Extremely small dimension perfect for Automatic FAUCETS

2. LONG LIFE

- The high-tech plastic materials are guarantee of durability

3. PERFORMANCE

- High flow and Low water hammer

4. LOW POWER CONSUMPTION

Voltage	Consumption	Power
3V	550mA	1W
4,5V	350mA	1,6W
6V	200mA	1,2W
12V	130mA	1,6W



RPE for the Sanitary Market

RPE MICRO

100%
MADE IN ITALY

8

RPE MICRO Range of voltage



SPECIFICATIONS

Model: 3 V Latching
Timing pulse: 15 ms
Protection: IP 55
Pulse shape: Rectangular pulse
Power (20° C): 1 W
Consumption (20° C): 330 mA



SPECIFICATIONS

Model: 4,5 V Latching
Timing pulse: 15 ms
Protection: IP 55
Pulse shape: Rectangular pulse
Power (20° C): 1 W
Consumption (20° C): 225 mA



SPECIFICATIONS

Model: 6 V Latching
Timing pulse: 15 ms
Protection: IP 55
Pulse shape: Rectangular pulse
Power (20° C): 1 W
Consumption (20° C): 165 mA



SPECIFICATIONS

Model: 12 V NC
Timing pulse: -
Protection: IP 55
Pulse shape: -
Power (20° C): 1,6 W
Consumption (20° C): 130 mA



SPECIFICATIONS

Model: 24 V NC
Timing pulse: -
Protection: IP 55
Pulse shape: -
Power (20° C): 1,6 W
Consumption (20° C): 165 mA



RPE for the Sanitary Market

RPE MICRO

100%
MADE IN ITALY

9

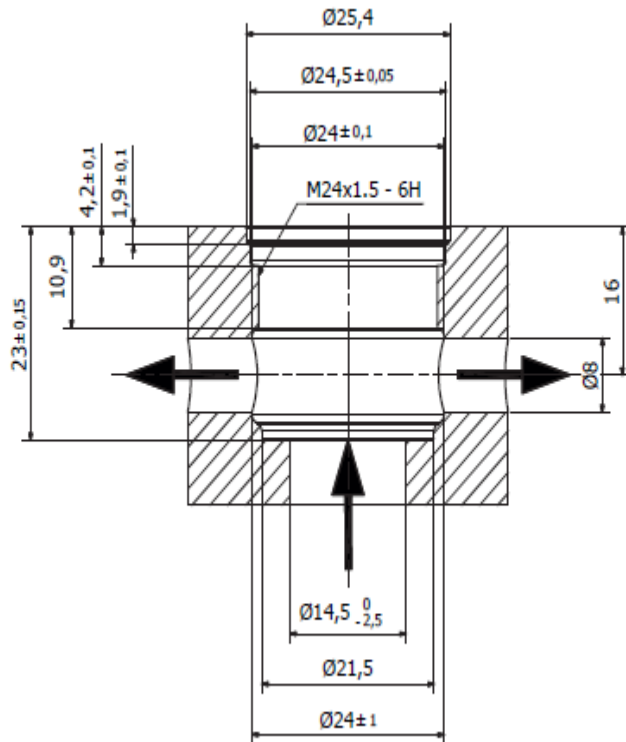

WORKING CHARACTERISTICS

Working pressure	0,2 - 8 bar / 2,9 - 116 psi
Room temperature	Tu 60°C
Fluid temperature	Tm 90°C
Control	Latching - NC
Orifice	DN 8 mm
Flow direction	Unidirectional
Working position	Universal

WATER CONNECTIONS

Inlet	M24 X 1,5
Outlet	OR seat

ELECTRICAL CONNECTIONS

Connection	Unipolar cables L 200mm
Connection	Cables with IP68



Micro Rpe Assembly

100%
MADE IN ITALY

10

- Electronic Faucets
- Household applications

ASSEMBLY PROCEDURE IS SIMPLE

- *Just push the MICRO on the
valve seat and screw it in!* -

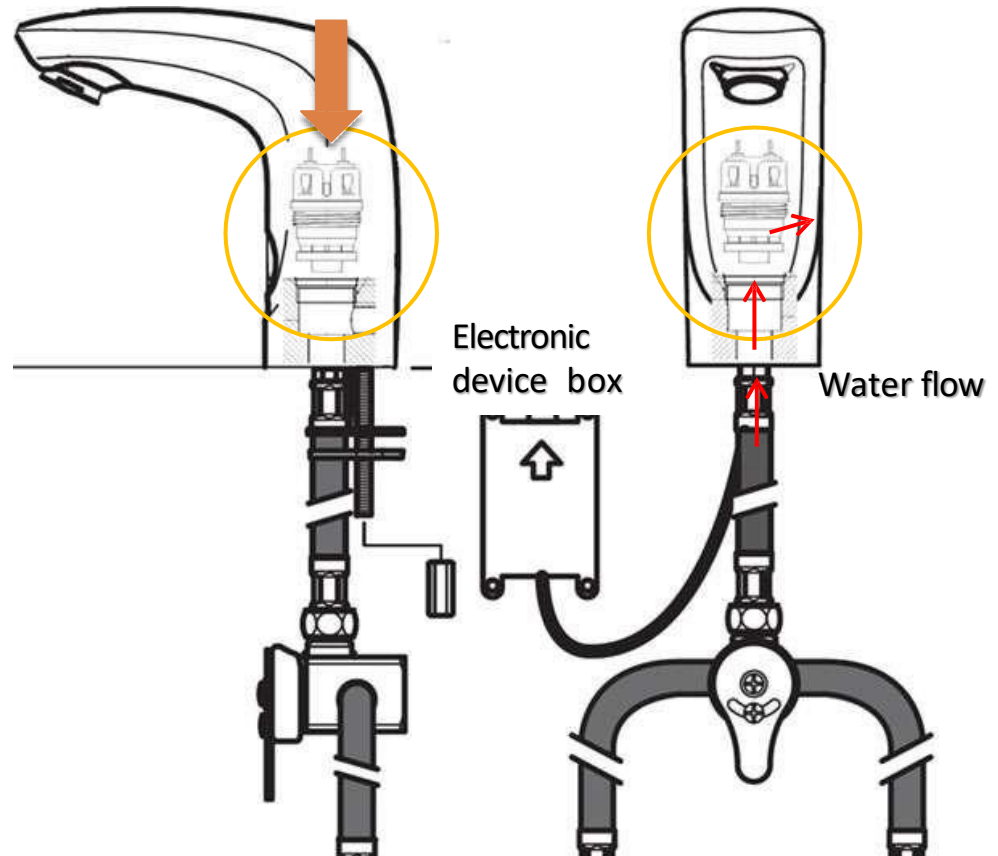

CHARACTERISTICS



- 2/2 WAY DN 8 - UNIDIRECTIONAL
- CONTROL: NORMALLY CLOSED, LATCHING
- WORKING PRESSURE: 0,5-10BAR (7.25-145PSI)
- FULLY FOOD GRADE APPROVED
- FLUID TEMPERATURE: TM 90°C (194°F)



AXIAL VALVE RPE

100%
MADE IN ITALY

12

ELECTRICAL FEATURES



NEW MICRO RPE	POWER (20° C)	CONSUMPTION (20° C)	RESPONSE TIME
3V LATCHING	1 W	330 mA	15ms
4,5V LATCHING	1 W	225 mA	15ms
6V LATCHING	1 W	165 mA	15ms
12V DC NC	1,6 W	130 mA	15ms
24V DC NC	1,6 W	130 mA	15ms

ELECTRICAL CONNECTIONS

STANDARD	OPTIONAL
FLYING CABLES LENGTH 200mm	MALE OR FEMALE CONNECTORS IP 68 CABLE LENGHT 100mm





AXIAL VALVE RPE

100%
MADE IN ITALY

13

OUTET

**QUICK COUPLING
PUSH FIT
JOHN GUEST 8mm**

EASY MOUNTING

**MAX
PRESSURE**

10 Bar

**Kv
VALUE**

13,58 L/min

INLET

**FLANGE AT BASE
2 SCREWS**

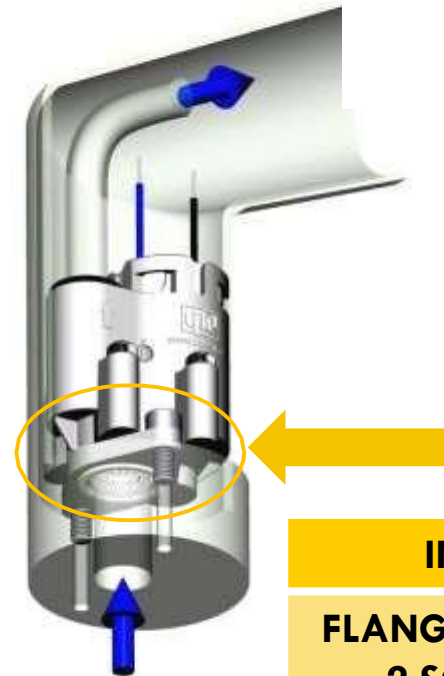
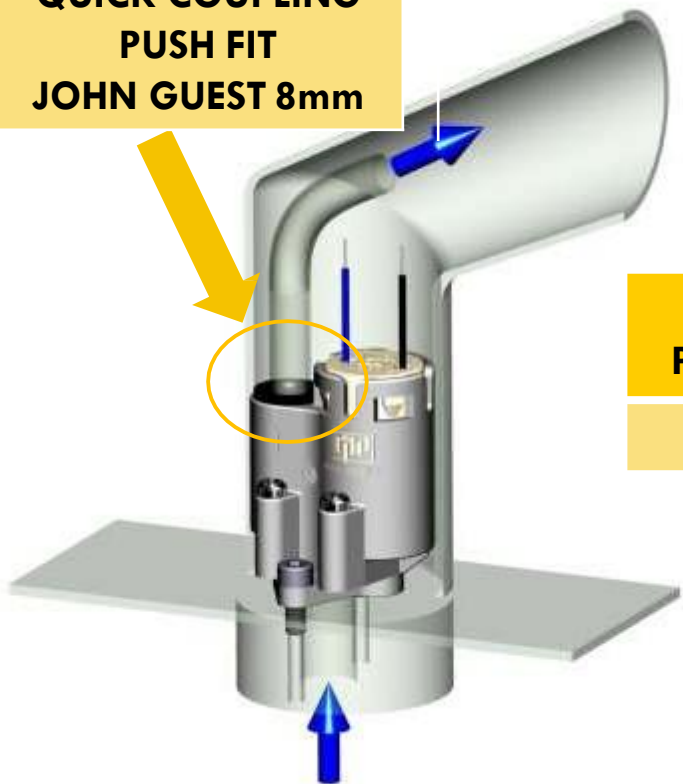



AXIAL VALVE RPE

100%
MADE IN ITALY

14

COMPACT AND PERFORMANT

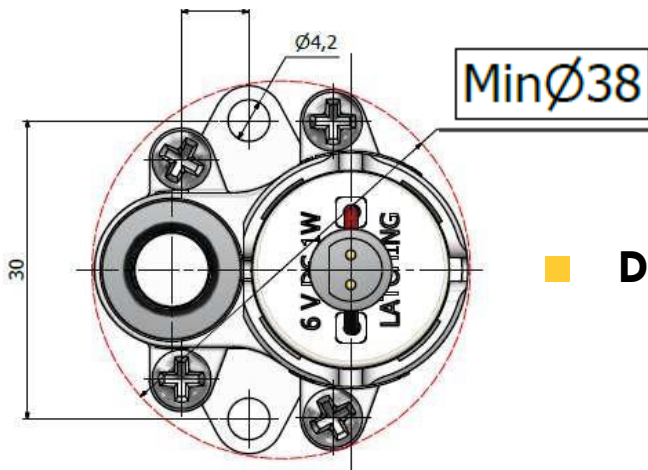

■ **DIAMETER: 38mm**

STANDARD

INLET FILTER 50 MESH



■ **HEIGHT: 46,5mm**

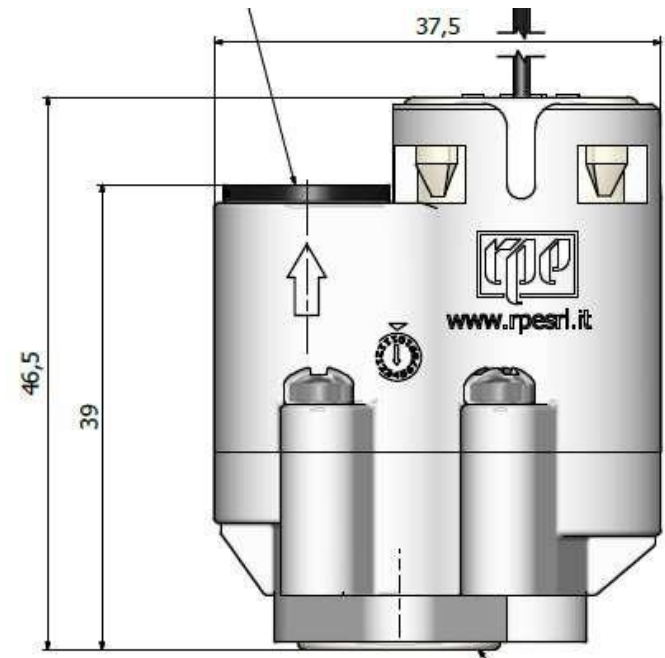



RPE for the Sanitary Market

3rd Series

100%
MADE IN ITALY

15

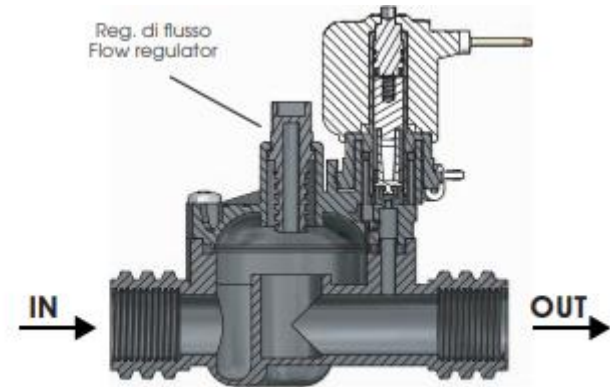

PHYSICAL SPECIFICATIONS

Valve body: PA 66 - 30% GF
Diaphragm: NBR
Core: Stainless steel
Coils: F Class (155°)
Assembly: With screws, serviceable

WORKING SPECIFICATIONS

Working pressure: 0,5 - 10 bar
Room temperature: Tu 60° C
Fluid temperature: Tm 60° C - ED 100%
Orifice: ND from 15 mm to 50 mm
Control: NC; NO; Latching
Fluid direction: Unidirectional

ELECTRICAL CONNECTIONS

Faston 6,3 x 0,8 mm
Unipolar wires max 600 mm
Bipolar wires 5000 mm

Modello Model	IN=OUT	M.O.Q. (pcs)	Diametro nominale Nominal diameter	Altezza Height	Lunghezza Length	Larghezza Width
530	1/2" F	24	15 mm	110 mm	114 mm	68 mm
630	3/4" F	24	20 mm	110 mm	114 mm	68 mm
631	3/4" M	24	20 mm	110 mm	114 mm	68 mm
730	1" F	24	25 mm	128 mm	128 mm	90 mm
731	1" M	24	25 mm	110 mm	100 mm	68 mm
830	1" 1/4 F	24	32 mm	128 mm	128 mm	90 mm
930	1" 1/2 F	12	40 mm	145 mm	137 mm	90 mm
1030	2" F	6	50 mm	180 mm	165 mm	120 mm
1131	3" M	6	50 mm	180 mm	170 mm	120 mm



RPE for the Sanitary Market

NEW Products to come!

100%
MADE IN ITALY

16

RPE R-MINI ADAPTOR FOR RPE MICRO

Can be used in any R-MINI Valve Body
90° or 180° no need of any special valve
housing, huge number of hydraulic connections

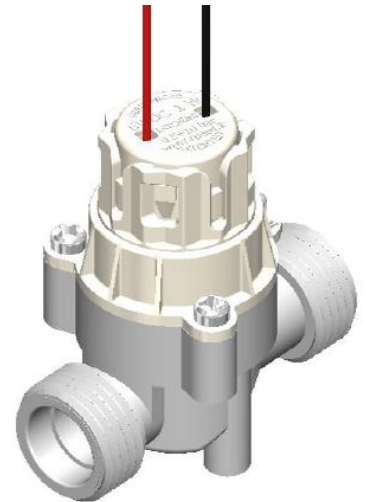



RPE for the Sanitary Market

NEW Products to come!

100%
MADE IN ITALY

17

Special and Customized solutions

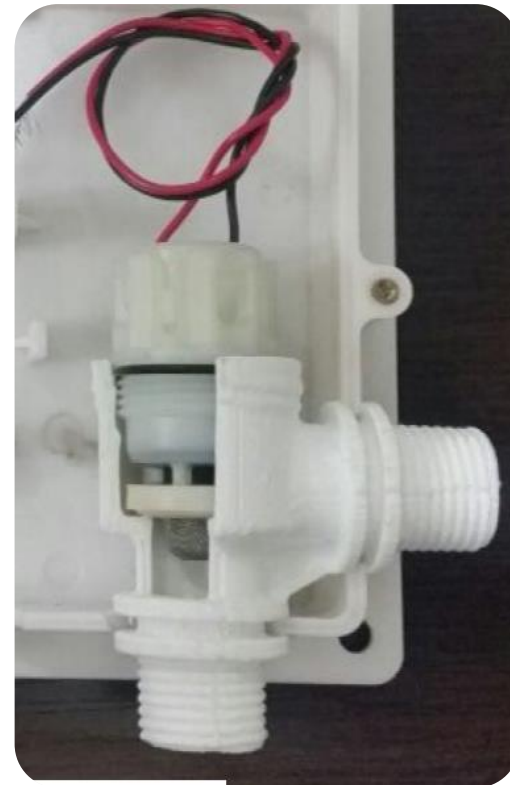

**Your new projects are
welcome!**



NOTHING GREAT HAS EVER BEEN DONE WITHOUT PASSION

100%
MADE IN ITALY

18

RPE recognizes quality control management as a top priority. Managing and improving quality standards is essential in achieving the objectives the market requires and for the positive development of our products

OUR CERTIFICATIONS

WRAS
Water Regulations Advisory Scheme



KTW



NOTHING GREAT HAS EVER BEEN DONE WITHOUT PASSION

100%
MADE IN ITALY



In RPE we pay attention to every single detail
Thanks for the attention



www.rpesrl.it